

SHAWNEE

non-lakeside



- 🏠 Longhouse; 7 one-room units
- 📍 Located on Main Street near Point tennis courts
- ♿ Units 4 & 5: bathroom with tub/shower combo

- ✚ Porch
- 🚫 No fire pits
- ♿ Units 1, 2, 3, 6, & 7 are handicap accessible with a walk in shower

Beds & Capacity by Unit

Units 2, 4, & 6: 2 twin beds can be converted to a king bed upon prior notice.

	Unit #	1	2	3	4	5	6	7
Beds	Twin		2		2		2	
	Bunk							
	Double							
	Queen	1		1		1		1
	King							
Capacity	Minimum	NA	2	NA	2	NA	2	NA
	Normal	2	2	2	2	2	2	2
	Maximum	3	3	3	3	3	3	3

Summer 2019 Pricing

Units 1, 3, 5, & 7: Contact Registrar for single occupancy rates.
Units 2, 4, & 6: No single occupancy.

Adult	7 - 13 yr old	1 - 6 yr old
\$735.00	\$377.65	\$63.00

SHAWNEE

Each unit is approximately 298 square feet

Units 1, 3 & 7

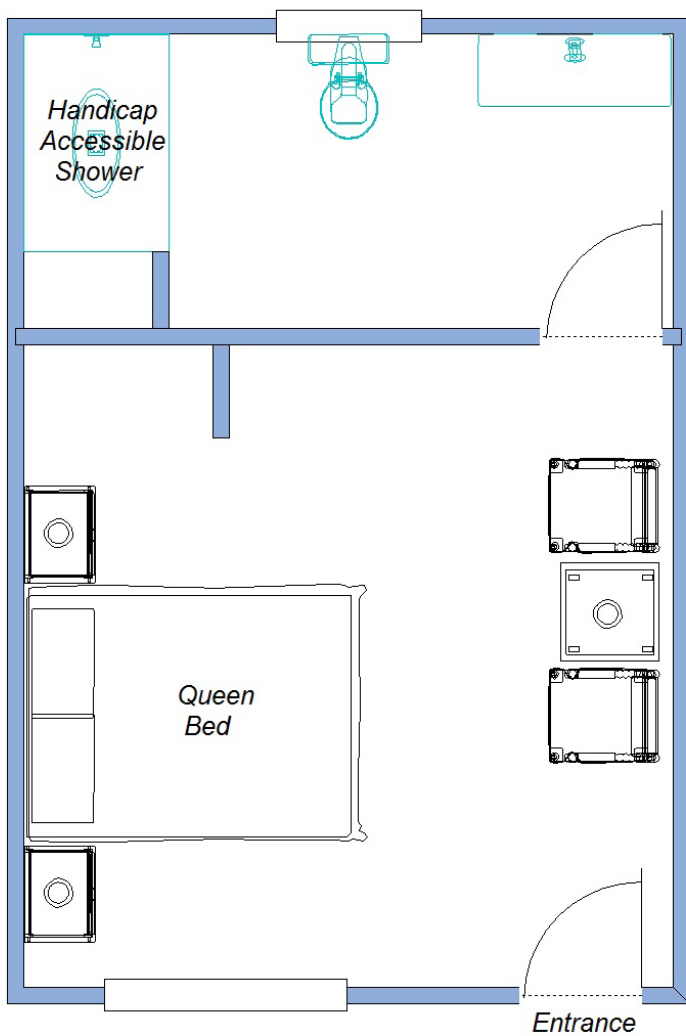

Units 2 & 6

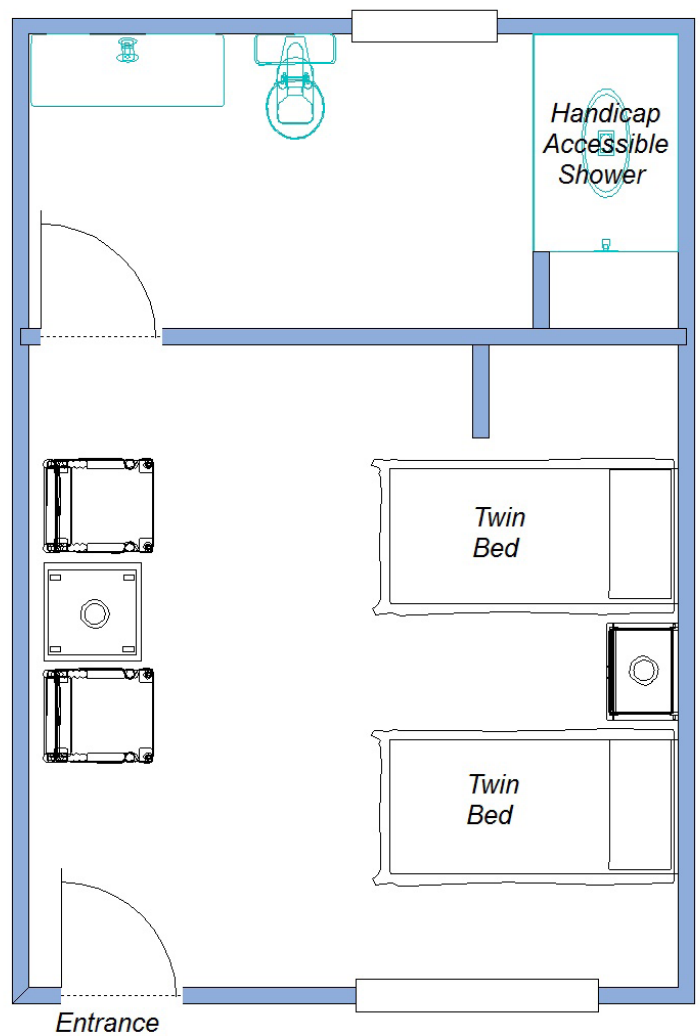

SHAWNEE

Each unit is approximately 298 square feet

Unit 4

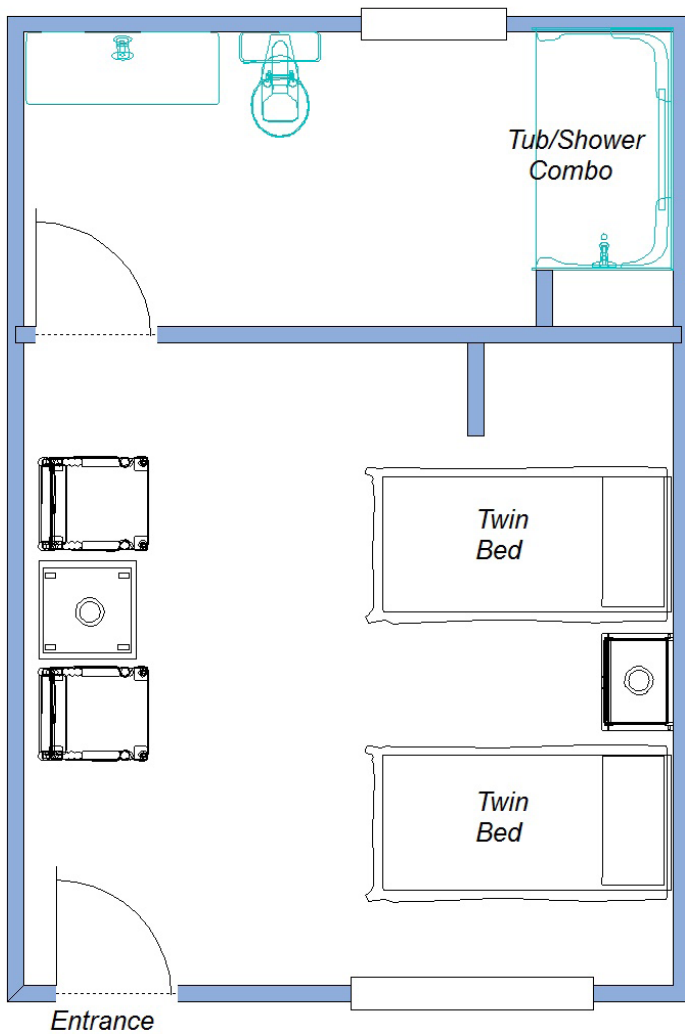

Unit 5

