

# Seneca



Longhouse with eight units on two levels. Located between Delaware and Tibbitts Auditorium. *Building under construction, Floor plans are subject to change.*

Each room has a bathroom with a tub/shower combo, carpet and porch. *Building under construction, floor plan is subject to change.*



## Beds & Capacity by Unit:

Unit #	Single	Bunk	Double	Queen	King	Normal Capacity	Maximum Capacity
11					1	2	3
12					1	2	3
13					1	2	3
14					1	2	3
21					1	2	3
22					1	2	3
23					1	2	3
24					1	2	3

- Please note that king beds can be converted into (2) twin beds upon prior no-***

**Summer 2012 Pricing:** Includes 21 meals at Hill Dining Hall. Gratuities not included.

	Adult	12-15 yr old	8-11 yr old	5-7 yr old	1-4 yr old	Single Occ.
Weeks 1-10	\$592.00	\$379.60	\$253.00	\$188.05	\$35.40	Call Registrar

## Renovation Information:

- Built for Summer 2012.

# Seneca

Units 11, 12, 13 & 14 Downstairs  
Units 21, 22, 23 & 24 Upstairs

Units 11, 13, 21 & 23  
Approximately 508 square feet

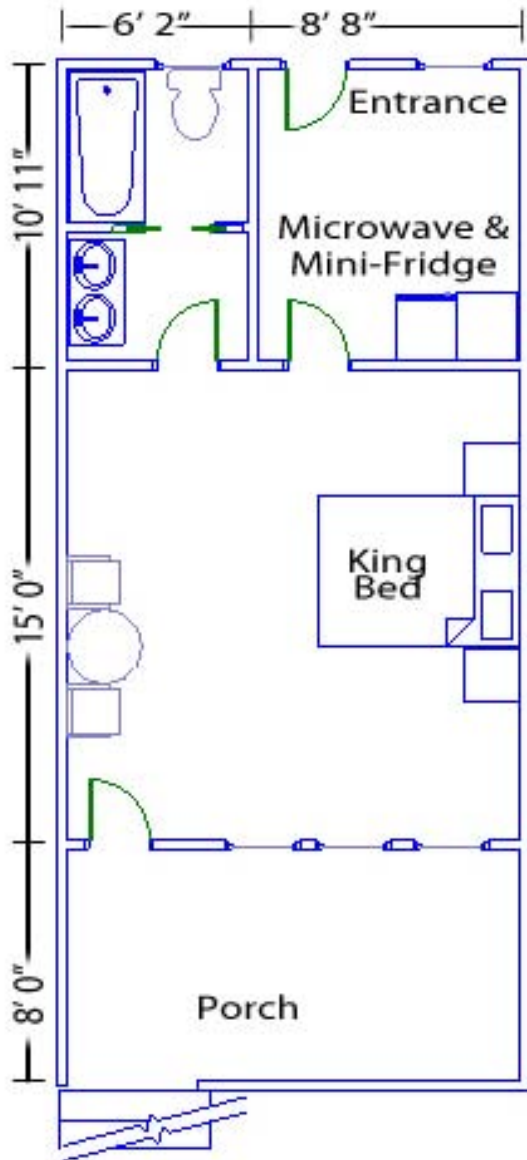

Units 12, 22 & 24  
Approximately 508 square feet

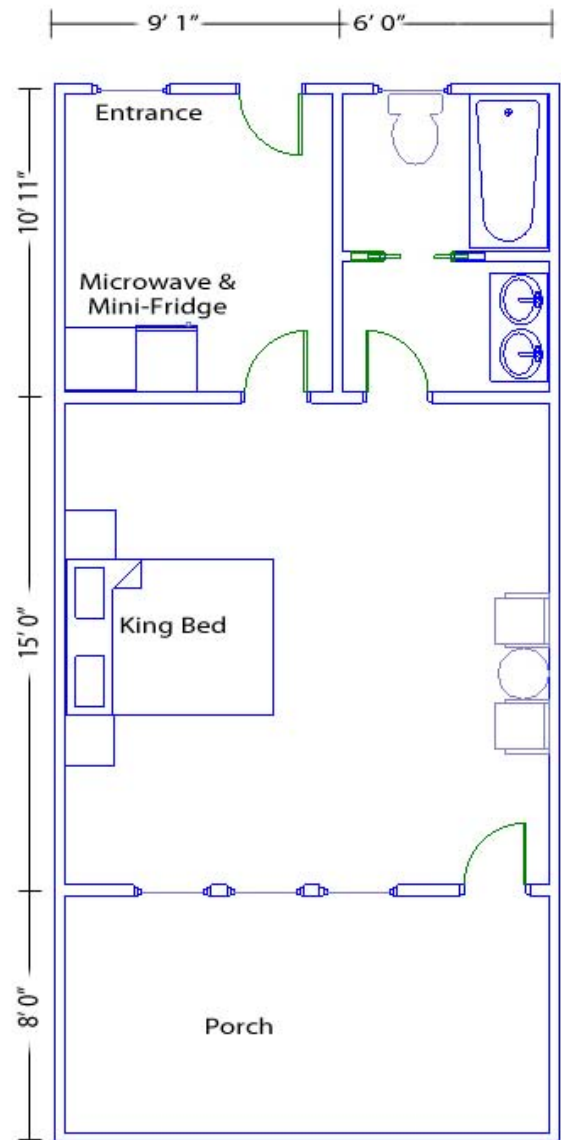

# Seneca

Unit 14: Handicap-Accessible  
Approximately 495 square feet

