



IDENTITY LEATHER CRAFT

for people who make, mend or adapt things out of leather



Heavy duty leather apron

A heavy duty leather apron, ideal for leather-crafters, knife makers, flint -napping, wood-workers, land-workers, foragers, silver-smithing, pyrography and more.

To make a similar apron to that pictured the materials you will need are listed on the following page:



Apron by Roy Goodwin from Soft Calf with Veg tan cowhide
Dyed Through Cognac blank strip.

www.identityleathercraft.com

Materials and Leather List

Leather – photo (dark brown leather hide – oil tanned calf) The leather pictured is a distressed pull up part vegetable tanned calf with some oils and waxes in the tannage. (Available in store and at shows only.)

Use 1.2-1.8mm veg tan side, or for a softer look use the soft finished calf. You will need approx. 6-8 sq ft.

Materials

The apron used authentic copper rivets but you could use any of the rivets – if going for double or single cap use medium size.

[11280-00](#) Copper Rivets size 9, you will need the 8110-00 Size 9 Rivet Setter if you don't already have.

(Useful video link for setting these rivets – [U-Tube Tandy Leather Factory Setting Copper Rivets](#))

[11311-01](#) Button Stud Large for shoulder strap, [Identity button stud \(Sam Browne Large\)](#)



[Clasp](#) and Dee or [Strap Buckle](#) 19mm 3/4" strap buckle for back fastening

1227-02 Waxed brown thread to stitch pocket

The leather shown is oil tanned calf – see the leather section or economy veg tan around 1.5mm (use heavier for blacksmithing), finished vegetable tanned hides.



ask for details, or look for finished calf pieces or English

All items available from the website, leather available in-store, at shows or by telephone order:

www.identityleathercraft.com

Suitable leathers

Dependant on end use eg bbq, blacksmithing, gardening, craft, café

Upholstery type, soft calf, oil tanned, veg tanned – combined?

Making a pattern



Style choice—Half Apron, Bib Apron, Apron Coverall

Research some images – make a newspaper template and adapt to fit – think about what you might be wearing before editing the final template – eg outside with a thick woolly jumper.

Consider available leather pieces and work out if seams are needed

Pockets and Tabs

What are you using apron for – will you need pockets for a pen, calculator, tools, for keys (eg till)

This will help you decide on pocket arrangement and sizes and whether the addition of hardware such as spring clip or dee ring would be helpful.

What you put in will decide

whether you need a rivet at the top of the stitching for example if there is a weighty item to go in.



Straps

These can be fixed in place but it can be an idea to make adjustable to allow for changes in clothing..

Adjustments can be made with a Sam Brown, two dees, or a buckle, or even velco.



Reinforced Areas

If you are using a lighter leather it can be a good idea to reinforce the top strap corners and the belt strap.

If you are using for heavy duty you might want to add reinforced panels of thicker leather for added protection eg for spoon carving or flint knapping.

www.identityleathercraft.com

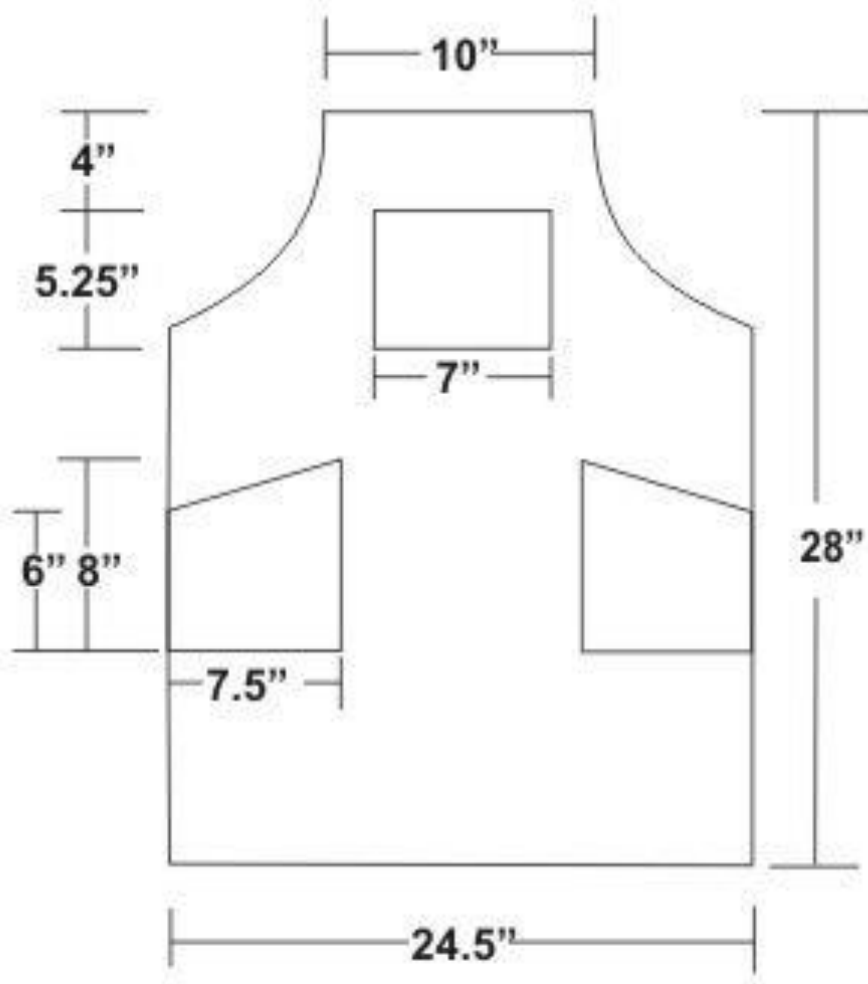

Other ideas – half apron, incorporate tool holders, back fastening braces detail for comfort, fastenings ideas





IDENTITY LEATHER CRAFT

Make-it-yourself!

HEAVY DUTY LEATHER APRON

