

ISLOTTA B, C, D, G, H, & J IS

lakeside



- ↑ Cabins; G: 3 rooms,
B, D, & J: 2 rooms, C: 1 room
- 🕒 Located along the lake near the point
- 🚿 B, C, & G: Tub/shower combo
C, D, H, & J: Shower

- ✚ Unit B has a screened in porch
- 🔥 B, D, G, H, & J have fire pits
- ♿ No handicap rooms

Beds & Capacity by Unit

	Unit	B	C	D	G	H	J
Beds	Twin	1		2		1	
	Bunk	1			1		1
	Double				1		
	Queen	1	1	1	1	1	1
	King						
Capacity	Minimum	3	NA	3	4	2	2
	Unit G: 2 Adult Rates Included in Minimum						
	Normal	5	2	4	6	3	4
	Maximum	6	3	6	8	4	5

Summer 2022 Pricing

Unit C: Contact Registrar for single occupancy rates.
Units B, D, G, H, & J: No single occupancy.

	Week	Adult	7 - 13 yr old	1 - 6 yr old
B, D, G, H, & J	Weeks 1 & 9	\$1,022.00	\$469.00	\$105.00
	Weeks 2, 3, 7, & 8	\$1,106.00	\$504.00	\$112.00
	Weeks 4, 5, & 6	\$1,141.00	\$525.00	\$119.00
C	Weeks 1 & 9	\$938.00	\$441.00	\$91.00
	Weeks 2, 3, 7, & 8	\$1,008.00	\$476.00	\$98.00
	Weeks 4, 5, & 6	\$1,043.00	\$497.00	\$105.00

ISLOTTA

Unit B



Lake Pleasant

ISLOTTA

Unit C

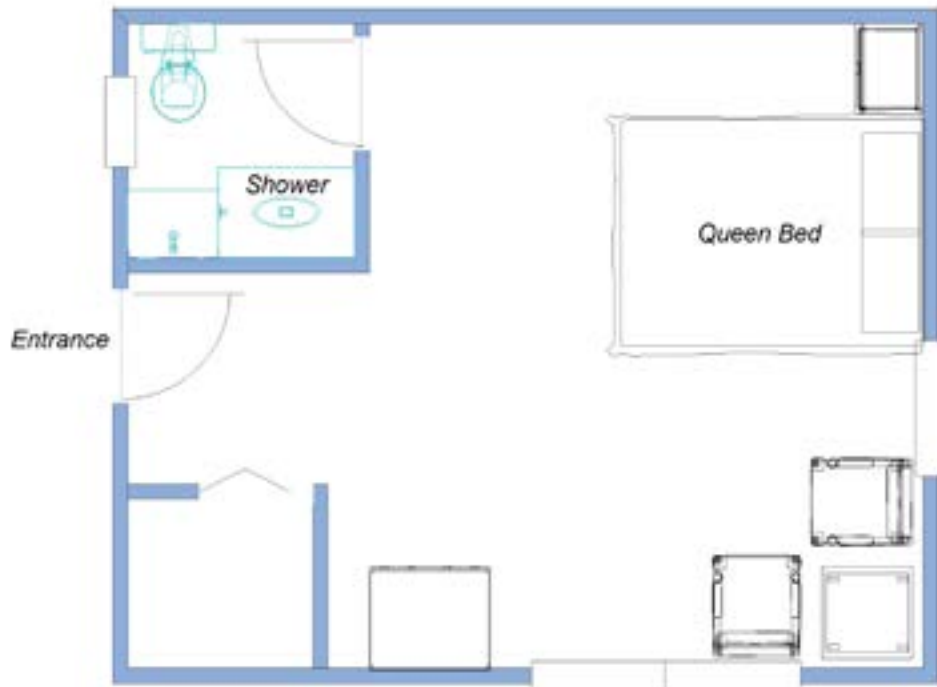

Unit D



ISLOTTA

Unit G
Approximately 490 square feet



Unit H



ISLOTTA

Unit J
Approximately 368 square feet

