



Parts and Accessories. Installation Instructions.

Seat Heating Retrofit BMW Z4 (E85)

Retrofit kit No.: 61 11 0 301 538

Installation time

The installation time is 8.5 hours, but this may vary depending on the condition of the car and the equipment in it.

Important information

These installation instructions are primarily designed for use within the BMW dealership organisation and by authorised BMW service companies;

In any event the target group for these installation instructions is specialist personnel trained on BMW cars with the appropriate specialist knowledge.

All work must be completed using the latest BMW repair manuals, circuit diagrams, servicing manuals and work instructions in a rational order using the prescribed tools (special tools) and observing current health and safety regulations.

Ensure that the cables/lines are not kinked or damaged as you install them in the car. The costs incurred as a result of this will not be reimbursed by BMW AG.

Additional cables/lines that you install must be secured with cable ties.

If the specified PIN chambers are occupied, bridges, double crimps or twin-lead terminals must be used.

All the figures show LHD cars, proceed accordingly on RHD cars.

Pictograms:



denotes instructions that draw your attention to dangers.



denotes instructions that draw your attention to special features.

◀ denotes the end of the instruction or caution text.

See the EBA CD or Aftersales Portal for explanations of the pictograms.

Do not archive the hard copy of these installation instructions since daily updates are made by Aftersales Portal.

Subject to technical modifications.

Installation information

Some of the installation is shown only on the left-hand side of the car, proceed in the same way on the right-hand side of the car.

After the installation work the retrofit kit must be programmed / coded using DISPlus or GT-1 via the **Retrofit** path.

Ordering instructions

The seat and backrest covers must be ordered separately in the appropriate colours.

Also, the centre console switch centre must be ordered separately depending on the equipment in the car. (See EPC for part numbers.)

Special tools required

Clip pliers (52 0 050)

Contents

Section	Page
1. Parts list	4
2. Preparations.....	5
3. Connection diagram.....	6
4. Installation and cabling diagram	7
5. To install the seat covers	8
6. To install and connect the wiring harness.....	9
7. Concluding work and coding	11
8. Circuit diagram	12

1. Parts list

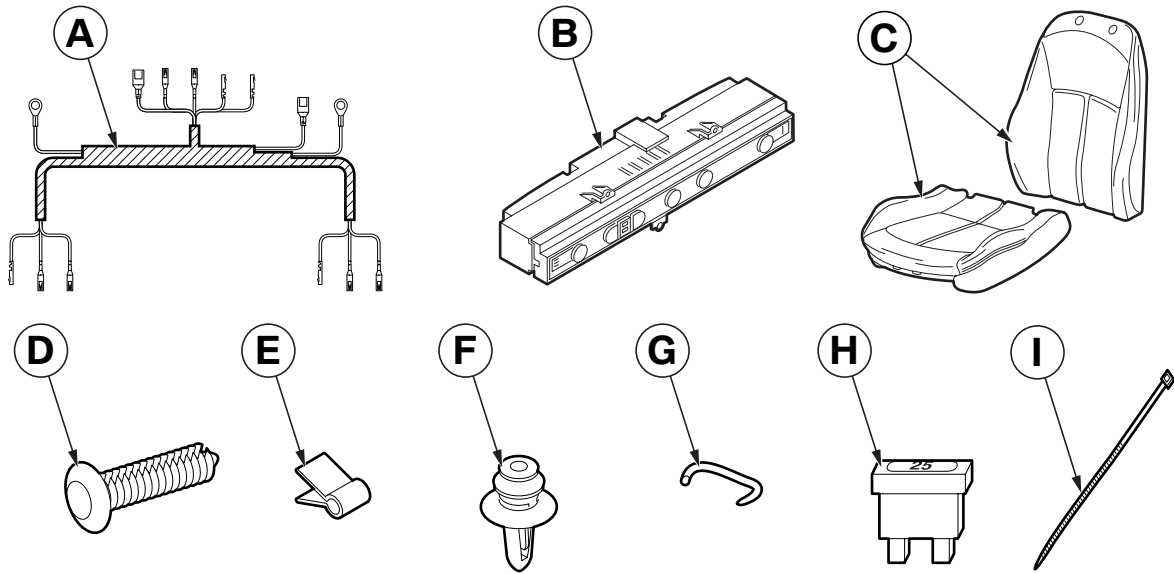

085 0179 Z

Legend

- A Wiring harness
- B Centre console switch centre (not included in kit)
- C Seat covers with seat heating (2x, not included in kit)
- D Set of fasteners for back wall of backrest (2x)
- E Trim clip (8x)
- F Entry cover clip (8x)
- G Seat cover clip (100x)
- H Fusible link 25 A
- I Cable tie (10x)

2. Preparations

	TIS No.
Conduct a brief test	---
Disconnect the negative pole of the battery	12 00 ...
The following components must be removed first of all	
Driver and passenger seat	52 13 000
Door sill strip interior on both sides	51 47 000
A pillar covers at bottom on both sides	---
Pedal trim	51 45 185
Glove compartment with casing	51 16 366
Undo the glove compartment fuse holder	---
Instrument panel trim at bottom on passenger side	51 45 181
Rear storage box trim	51 16 235
Centre console oddments box	51 16 200
Centre console switch centre	---
Seat and backrest cover, driver's and passenger's seats	52 13 ..., 52 14 ...

3. Connection diagram

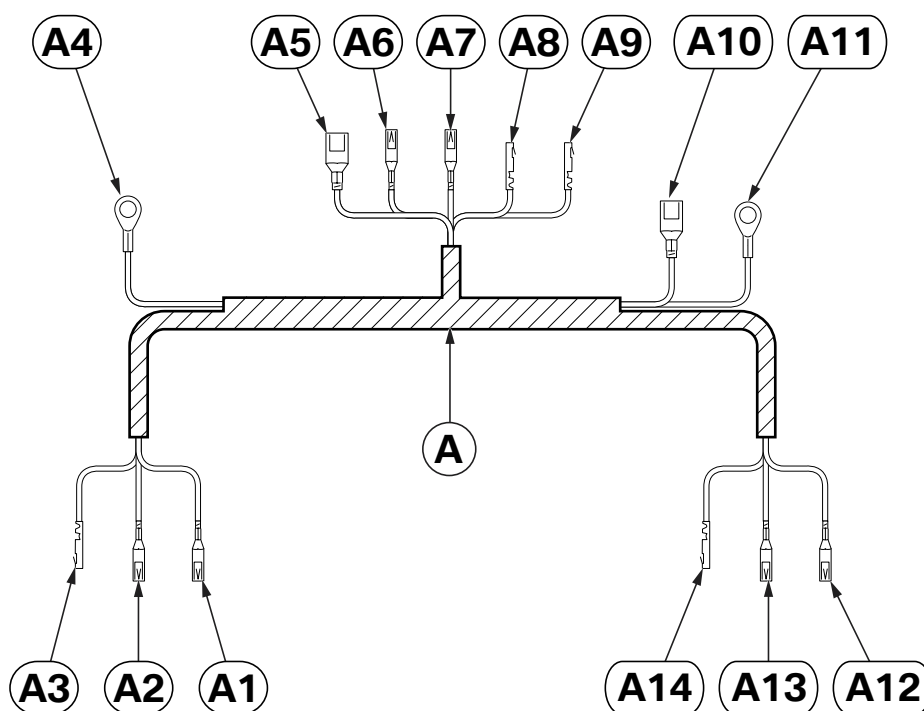

085 0180 Z

Item	Description	Signal	Cable colour / Cross-section	Connection location in the car	Abbreviation / Slot
A	Wiring harness	---	---	---	---
A1	Socket contact	HZFA	GN/VI 2.5 mm ²	In 25-pin plug, driver's seat	X275 PIN 25
A2	Socket contact	Terminal 31	BR 2.5 mm ²	In 25-pin plug, driver's seat	X275 PIN 24
A3	Socket contact	NTCFA	WS/GN 0.35 mm ²	In 25-pin plug, driver's seat	X275 PIN 23
A4	Eyelet M6	Terminal 31	BR 2.5 mm ²	On earth post connection front left	X9633
A5	Socket contact	30<16	RT/VI 4.0 mm ²	In 23-pin plug, switch centre	X1869 PIN 7
A6	Socket contact	HZBF	GN/GE 2.5 mm ²	In 23-pin plug, switch centre	X1869 PIN 1
A7	Socket contact	HZFA	GN/VI 2.5 mm ²	In 23-pin plug, switch centre	X1869 PIN 13
A8	Socket contact	NTCBF	WS/BL 0.35 mm ²	In 23-pin plug, switch centre	X1869 PIN 20
A9	Socket contact	NTCFA	WS/GN 0.35 mm ²	In 23-pin plug, switch centre	X1869 PIN 21
A10	Socket contact	30<16	RT/VI 4.0 mm ²	In plug X11004 on fuse holder	X11004 PIN 1
A11	Eyelet M6	Terminal 31	BR 2.5 mm ²	On earth post connection front right	X9634
A12	Socket contact	HZBF	GN/GE 2.5 mm ²	In 25-pin plug, passenger's seat	X279 PIN 25
A13	Socket contact	Terminal 31	BR 2.5 mm ²	In 25-pin plug, passenger's seat	X279 PIN 24
A14	Socket contact	NTCBF	WS/BL 0.35 mm ²	In 25-pin plug, passenger's seat	X279 PIN 23

4. Installation and cabling diagram

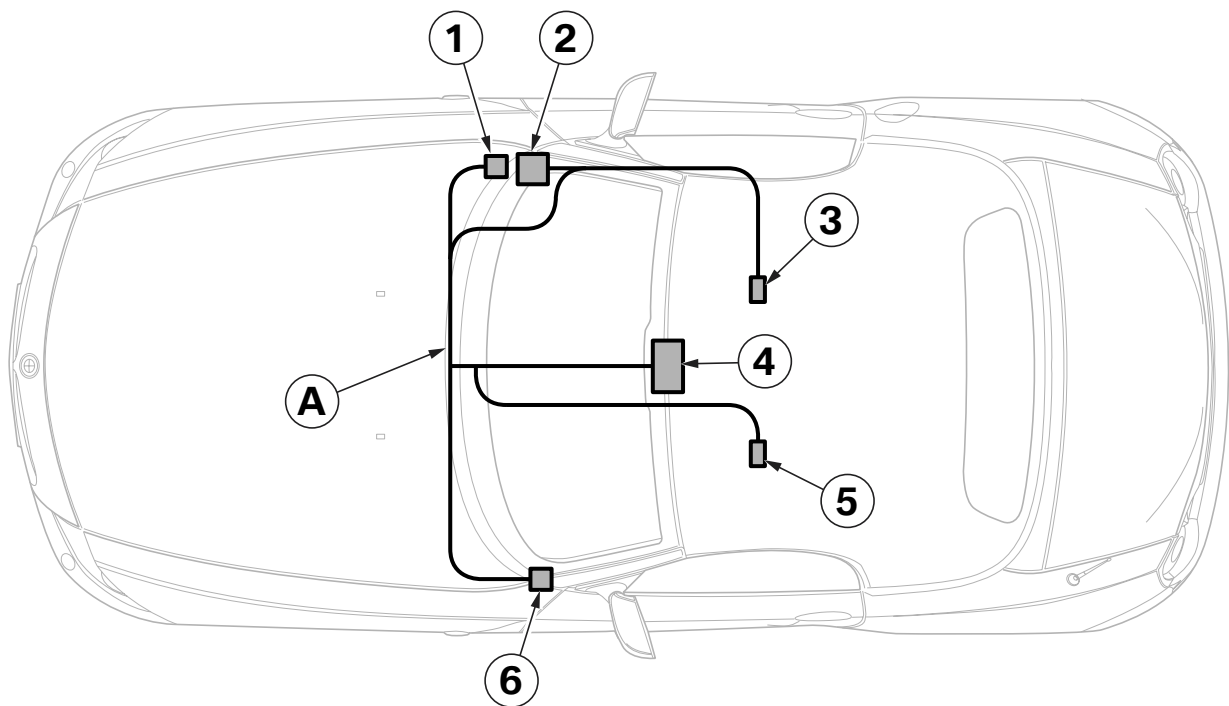

085 0181 Z

Legend

A Wiring harness

- 1 Earth post connection right **X9634**
- 2 Fuse box
- 3 Passenger's seat plug **X279**
- 4 Centre console switch centre
- 5 Driver's seat plug **X275**
- 6 Earth post connection left **X9633**

5. To install the seat covers



Install seat covers **C** as described in TIS RA no. 52 13 ... or 52 14

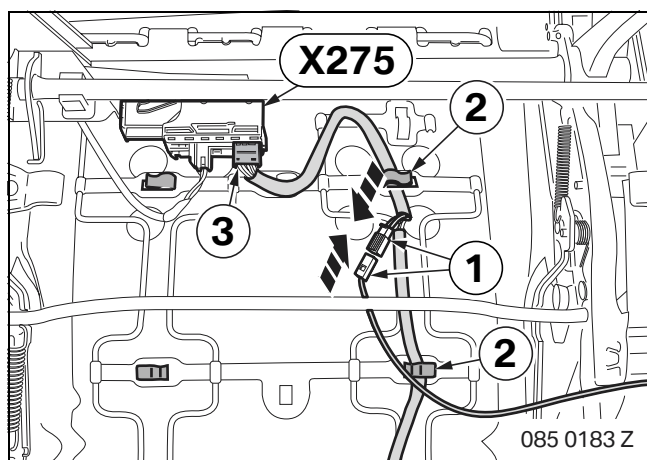

Connect the connection cables (1) of the heated covers for the seat base and backrest under the seat and clip them into the mountings (2).

Insert the plug (3) of the seat heating into seat plug **X275**.

6. To install and connect the wiring harness

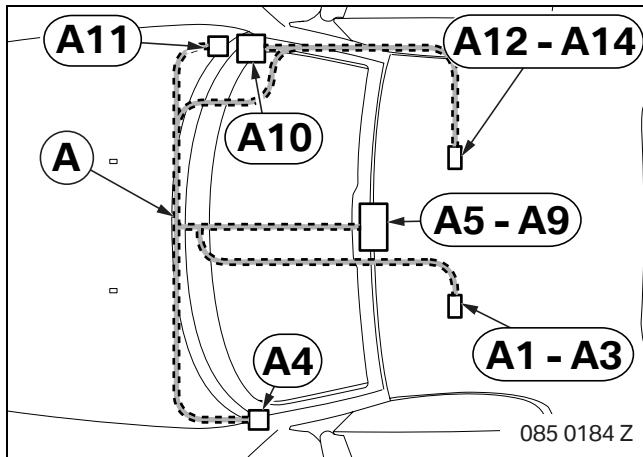

Route wiring harness **A** in the car and attach it to the existing wiring harnesses. Fold back the carpet below the seats and thread the wiring harness through the existing openings.

Branches **A1 – A3** under the driver's seat

- Branch **A4** to left earth post connection
- Branches **A5 – A9** to the switch centre
- Branch **A10** to the fuse holder
- Branch **A11** to right earth post connection
- Branches **A12 – A14** under the passenger's seat

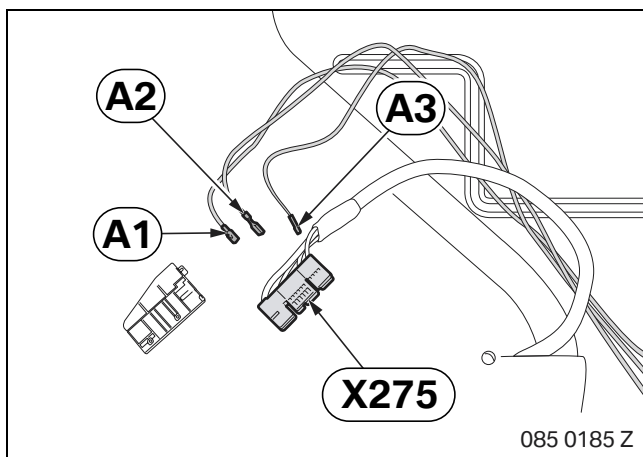

Connect branches **A1 – A3** to driver's seat plug **X275** as follows:

- **A1**, green/violet cable, in PIN 25
- **A2**, brown cable, in PIN 24
- **A3**, white/green cable, in PIN 23

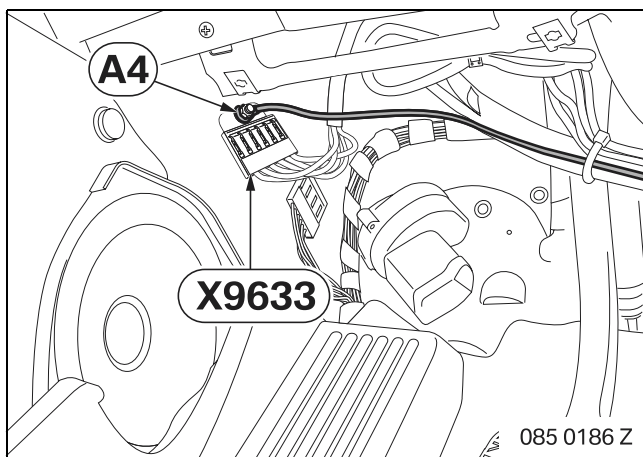

Connect branch **A4** to earth post connection **X9633** in the footwell at the front left.

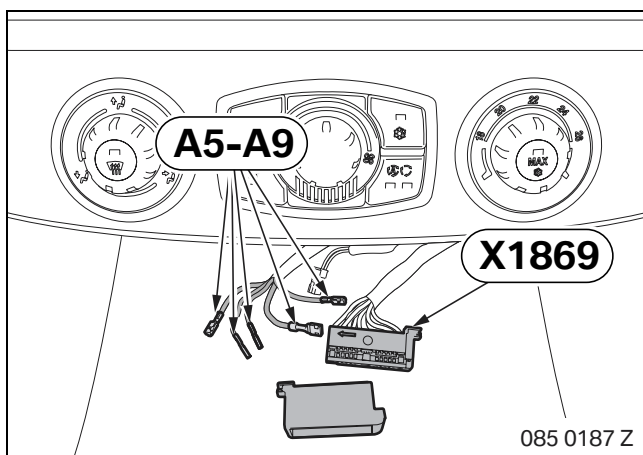

Connect branches **A5 – A9** to switch centre plug **X1869** as follows:

- **A5**, red/violet cable, in PIN 7
- **A6**, green/yellow cable, in PIN 1
- **A7**, green/violet cable, in PIN 13
- **A8**, white/blue cable, in PIN 20
- **A9**, white/green cable, in PIN 21

Connect plug **X1869** to the centre console switch centre.

6. To install and connect the wiring harness

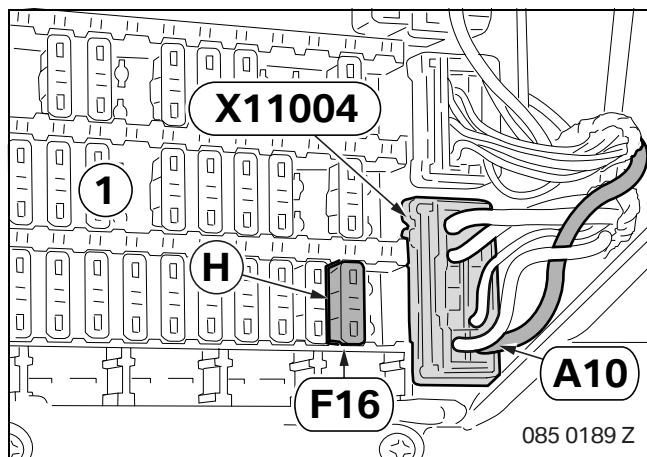

Connect branch **A10** to PIN 1 on plug **X11004** of fuse holder (1).

Insert fusible link **H** into slot **F16** of the fuse holder (1).

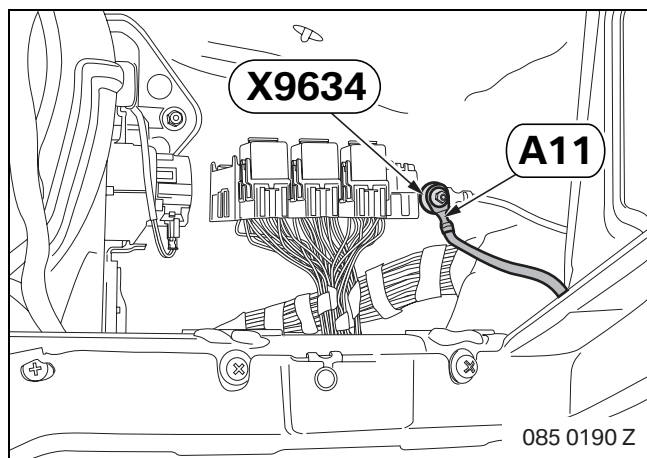

Connect branch **A11** to earth post connection **X9634** in the footwell at the front right.

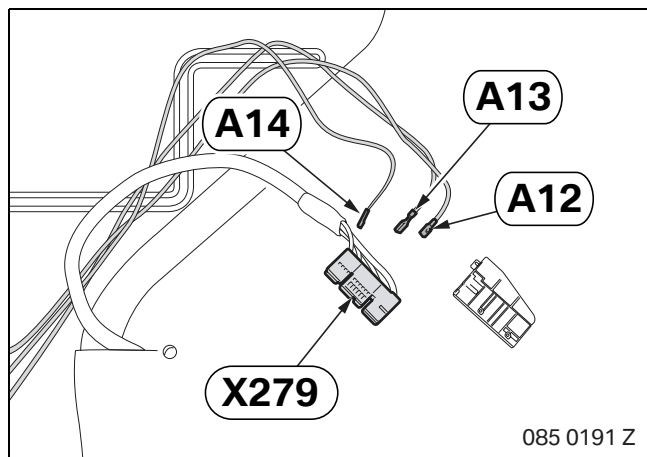

Connect branches **A12 – A14** to passenger's seat plug **X279** as follows:

- **A12**, green/yellow cable, in PIN 25
- **A13**, brown cable, in PIN 24
- **A14**, white/blue cable, in PIN 23

7. Concluding work and coding

- Install and connect the seats
- Connect the battery
- Code the retrofit using DISPlus or GT-1 via path **Retrofit**
- Conduct a brief test
- Conduct a function test
- Re-assemble the car

8. Circuit diagram

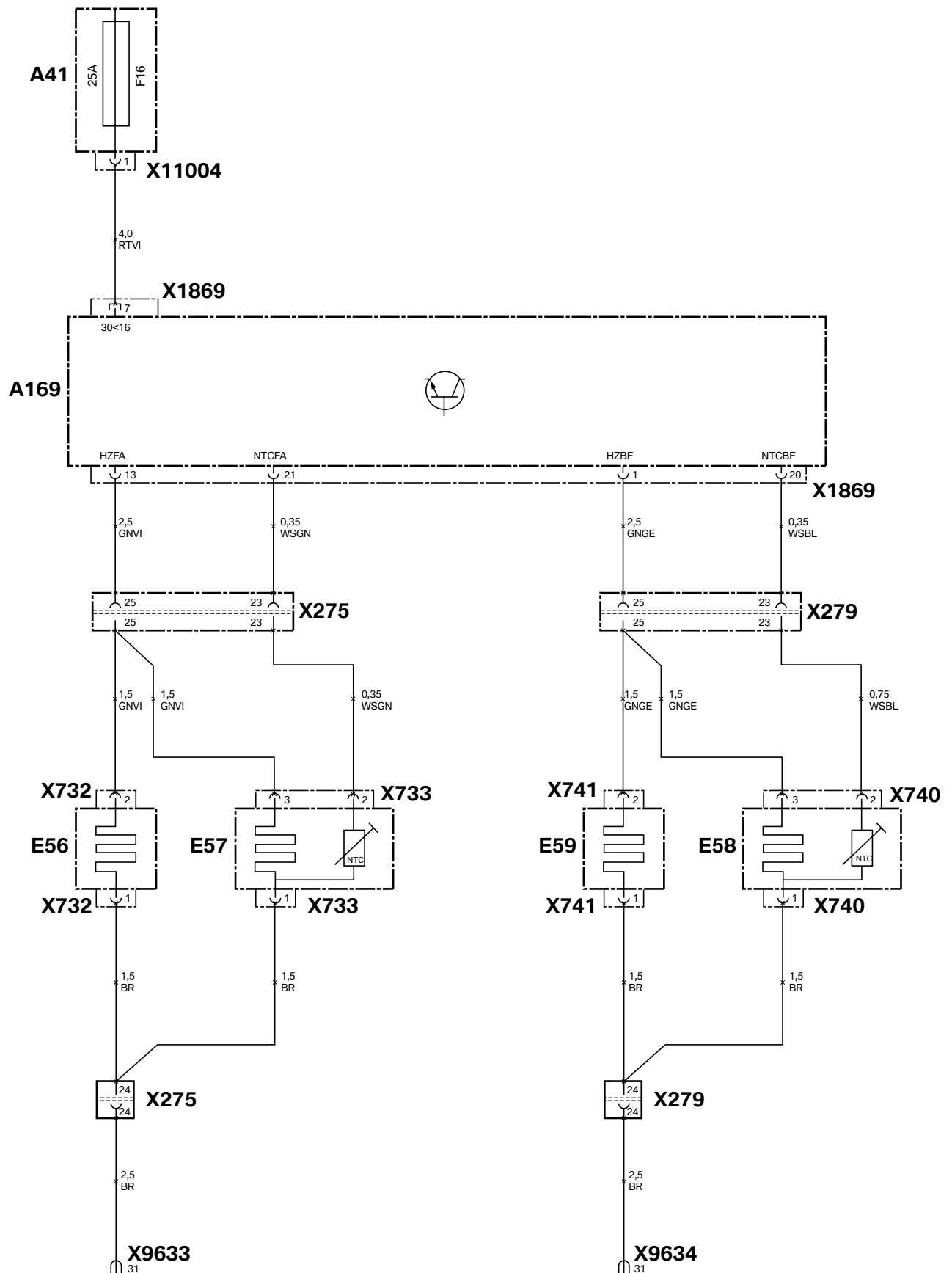

085 0192 Z

8. Circuit diagram

Legend

A41	Glove compartment fuse holder
A169	Switch centre
E56	Driver's seat backrest heating
E57	Driver's seat heating
E58	Passenger's seat heating
E59	Passenger's seat backrest heating
X275	Black/yellow 25-pin plug, driver's seat
X279	Black/yellow 25-pin plug, passenger's seat
X732	2-pin plug, driver's seat backrest heating
X733	3-pin plug, driver's seat heating
X740	3-pin plug, passenger's seat heating
X741	2-pin plug, passenger's seat backrest heating
X1869	23-pin plug, switch centre
X9633	Earth post connection front left
X9634	Earth post connection front right
X11004	Black/brown 23-pin plug on switch centre

Cable colours

BR	Brown
GE	Yellow
GN	Green
GR	Grey
RT	Red
SW	Black
VI	Violet
WS	White