

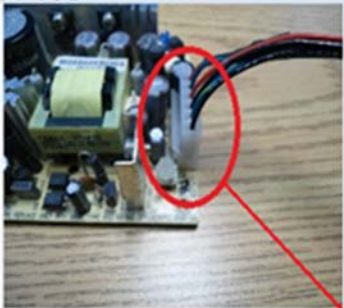

P2 Power Supply Voltage Adjustment Service Advisory	
Ref #: SA1001	
Date: Sept 2, 2014	
Issue: The Display Screen becomes non-functional or no information is on the display.	
<p>Step #1</p> <p>If available, apply silicone grease (PB6231) to the power connectors shown in the picture on the right.</p> <p>Unplug each connector and apply the grease to the sockets and plug the connectors back together.</p> <p>The silicone grease will reduce contaminants and moisture from contacting the pins thereby reducing the contact corrosion resistance.</p>	<div><div>Power plug on Power Supply</div><div>Power Plugs on Display Panel Unit</div><div>Power plug on SMA106</div><div>Silicone Grease</div></div>
<p>Step #2:</p> <p>Locate the 5 VDC trim pot on the PT2324 power supply.</p>	

Voltage output pins are identified on this picture.

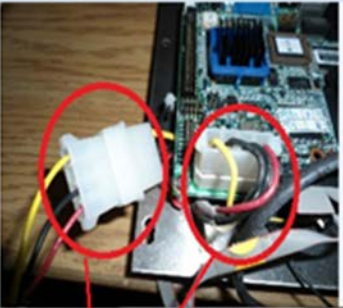

Step #3

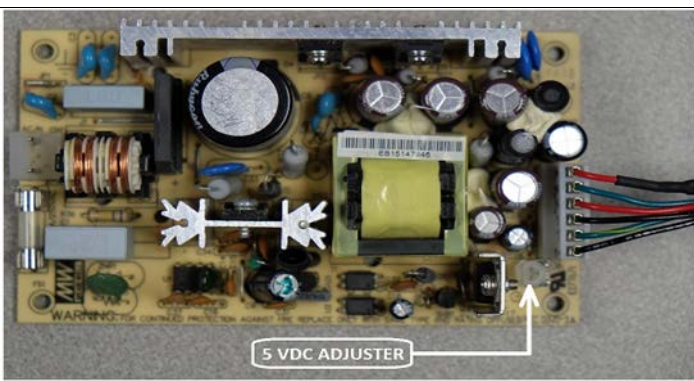
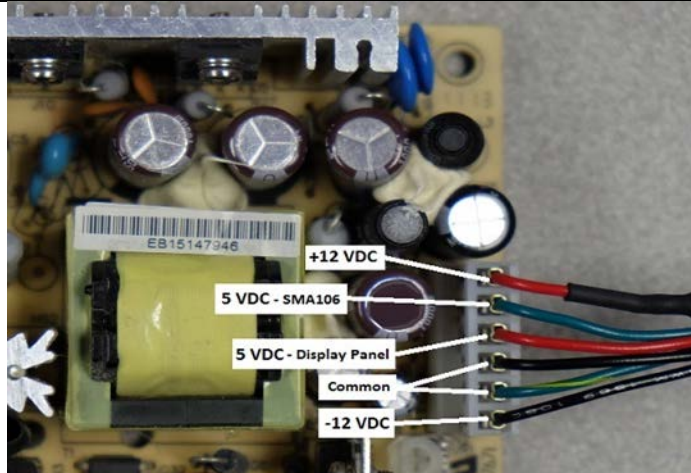
Position the leads of a digital voltmeter on the 5 VDC and common pins.

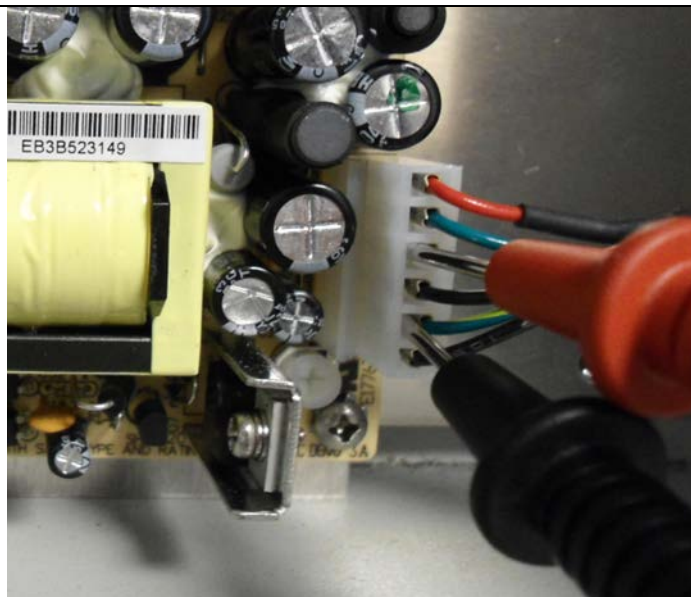

Step #4

Adjust the voltage to 5.10 VDC by very slowly rotating the potentiometer. Only a small adjustment is required. Make sure all the power connections are plugged in to their respective places before commencing the adjustment.

