

SAN MARCO Dreamette

Dear Friends & Neighbors,

Thank you for welcoming San Marco Dreamette to your neighborhood!

In order to maintain a safe & courteous environment, please observe the following guidelines regarding parking & outdoor eating:

Parking

Please park in (1) Turner Plumbing parking lot, (2) Aspire Church Parking Lots (across the street, or (3) in any nearby public parking space (ex. San Marco Square, on-street parking, etc.). Always use the crosswalk for safety.

Please help us be good neighbors and do not park or assemble in the lot, even for a minute, at Harris Guidi Rosner law firm next door.

Outdoor Eating

We encourage customers to dine (1) on the benches in front of our building, (2) in the Turner Plumbing parking lot, (3) across the street, (4) in their vehicles, or (5) as you stroll through beautiful San Marco. Please do not assemble on the property of neighboring businesses.

Children should always be carefully supervised. Hendricks Ave. is a busy street and cars frequently drive in and out of adjacent parking lots very quickly. Please stay a safe distance from all traffic.

- Please do not climb on the rails in front of Dreamette.
- Please do not litter. Garbage cans are located in front of our building.

Thank you for your ongoing cooperation. **Enjoy your ice cream!**

(See attached **map**)

Warmly,
San Marco Dreamette

Harris Guidi
Rosner
Law Firm

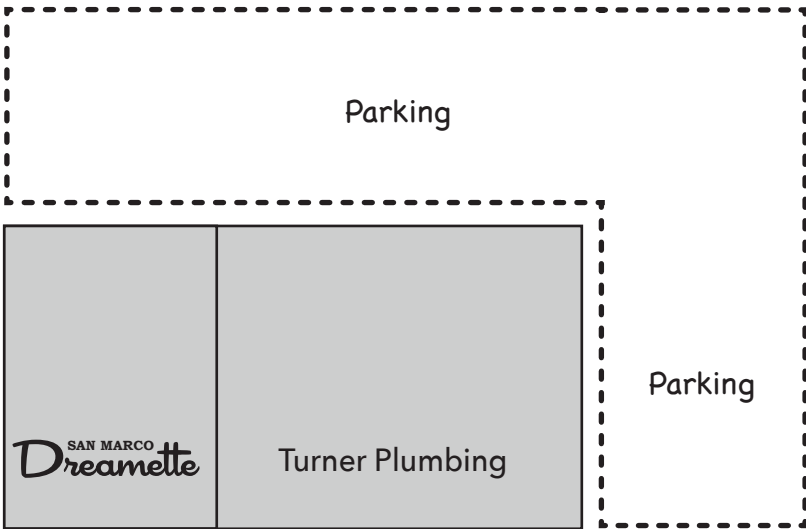
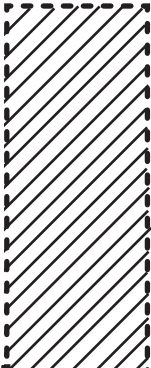

Foliahōm

NO Parking
at any time
(Towing sign posted)

Hendricks Ave.

Crosswalk



Hendricks Ave.

San Marco Place

To Parking
(San Marco Square)



San Marco
Community
Center
(Aspire Church)