

## GENERAL SUGGESTIONS

**IF LANTERN BLAZES AND SMOKES** more than a few seconds when first lit, then close valve and re-open one-fourth turn as soon as light dims.

**IF LANTERN DOES NOT LIGHT** check air pressure and fuel content. Open valve slightly to make sure gasoline will come through. Remove Generator and unscrew Gas Tip to make sure point of needle has not been bent or curled.

**IF MANTLE TURNS BLACK**, make sure screens in Burner Caps are clean and open. Check Air Intake Tube for possible obstruction, such as a spider's nest.

**IF LIGHT DIMS**, check Fuel Valve to be certain it is wide open. Rotate cleaning lever to remove carbon, if any.

**IF LIGHT PULSATES** after installation of a new Generator, pump in additional air pressure until light is steady.

**IF LANTERN IS ON EMERGENCY STANDBY** in case of storm or power failure, empty all gasoline from Fount and, when cool, refill with clean, fresh fuel. Store in as cool a place as possible.

**TO TEST BUILT-IN PUMP** for air pressure leak, tip Fount and place end in a full glass of water.

**IF YOU HAVE OCCASION TO WRITE** the dealer or the factory, mention whether yours is a No. 220E or No. 228E Lantern. If you mail the lantern, send it less Globe and Ventilator to avoid breakage.

**NOTICE:** The use of any attachment or device that is not expressly approved by The Coleman Company, Inc., to alter or affect the operation of the appliance automatically cancels all warranties, implied or expressed. Furthermore, the Company shall not be liable for any consequences that result from the use of equipment under these circumstances.

Made in United States of America

**THE COLEMAN COMPANY, INC.**

General Office and Factory: WICHITA 1, KANSAS, U. S. A.

Canadian Office and Factory: Toronto, Canada

F 7930

Litho. in U. S. A.



**LANTERNS  
220E AND 228E**

TO OBTAIN SATIS-  
FACTORY RESULTS  
READ AND FOLLOW  
THESE INSTRU-  
CTIONS CAREFULLY  
STEP BY STEP...

DIRECTIONS FOR OPERATING AND SERVICING

\* DIRECTIONS FOR OPERATING AND SERVICING

# HOW TO USE YOUR

**Coleman**

## 220E and 228E LANTERN



*Follow the directions and use only Coleman S & L Fuel or "White" unleaded gasoline for long, trouble-free service.*

### To Fill

Close fuel valve tightly to the right. Remove Filler Cap and fill lantern with 2 pints of fresh, clean fuel (Coleman S & L Fuel, for example). Never use fuel containing lead compounds for lubricating oils. Lantern should sit level all during filling. Fuel for the lantern should be strained through several thicknesses of finely woven cloth or, more convenient, a No. 0 Coleman Filtering Funnel. After filling, replace Filler Cap and tighten with fingers.

### To Pump

Fuel Valve must be closed. Turn Pump Plunger 2 turns to the left. Place thumb over small hole in end of Pump Plunger and pump 35 to 40 full strokes of air into lantern. Good pressure is im-

portant. Now turn Pump Plunger clear to right and push it clear down. Oil Pump Leather occasionally to keep it soft and pliable.

### To Tie On Mantles

Remove nut at very top of lantern. Lift off the ventilator and take out the Pyrex Glass Globe. Tie mantles around grooves in burner caps (see drawing). Flat side of mantles should face generator. Distribute folds of mantle evenly at top and cut off surplus string. Burn mantles according to instructions on mantle envelope.

### To Light

Rotate the Cleaning Needle Lever at base of frame. Several turns will clean the Generator Tip. Leave lever pointing down. Open Fuel Valve one-fourth turn. Push lighted match through lighter hole and hold it under mantles. Mantles will light instantly when air

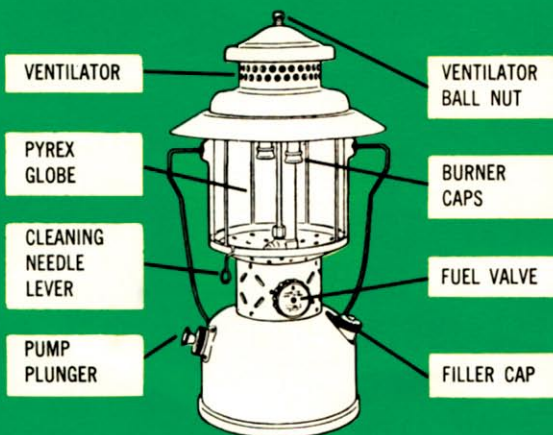

### ALWAYS USE GENUINE COLEMAN MANTLES



They are made without side seams and are reinforced at the bottom where gas pressure is greatest.

They are made especially for Coleman Lanterns, have the right size, shape, texture, and chemical treatment to give Coleman's usual extra brilliance.

Insist on Coleman Mantles. We recommend the heavy-duty No. 21A Silk Lite Mantle.



and gas mixture reaches them. When Mantles burn brightly, open Fuel Valve *all the way to the left*. Opening them all the way is important. Pump in additional pressure to insure long operation. If lantern does not burn brightly with Fuel Valve wide open, rotate Cleaning Needle Lever several times. Lantern may flicker a bit but should quickly steady down.

### To Turn Out Light

Rotate Cleaning Needle Lever several times. Then close Fuel Valve. Light will dim and go out in a few seconds.

### To Change Generators

Be sure Fuel Valve is closed. Turn Cleaning Needle lever up. Unscrew Jamb Nut at lower end of Generator. Lift Generator and unhook Gas Tip Cleaning Needle.

To install new Generator: Pull Cleaning Needle down about one inch. Slide Jamb Nut down over generator. Place Cleaning Needle between forefinger and thumb with Generator in upright position. Push gas tip end of Generator into Air Intake Tube and hook Needle through hole in Eccentric Block. Tighten Jamb Nut only enough to prevent leakage.

### Cleaning Lantern

Rinse Fount occasionally with clean fuel to prevent sediment or moisture accumulations. Clean Burner Cap Screens with small brush prior to installing new mantles.

EMPTY FUEL if lantern will not be used for several weeks. Emptying prevents gum accumulation in Fount.

AMBER COLORED GLOBES of Pyrex are available for night use when flying insects are bothersome.

other Coleman products  
to add to your  
outings fun!



### NEW SNOW-LITE PICNIC JUGS

The only 100% insulated jugs. Hold heat or cold twice as long. Lightweight Therma-Lock styrene insulation can't pack down. Spout and faucet models. "Pitcher-Pour" and tubular handles, one- and two-gallon sizes. Custom and deluxe models. Three beautiful colors.

### SNOW-LITE COOLERS

Holds cold 45% longer. Therma-Lock styrene insulation throughout. Royalite base, interior and lid liner are seamless; can't leak, rust, corrode, or stain. Rounded corners. Easy to clean, always odor-free. "Steel Beam" base construction easily supports heaviest load. Available in patio pink, charcoal, green. Two sizes, choice of handles.



GENERATOR

JAMB NUT

GAS TIP  
CLEANING  
NEEDLE

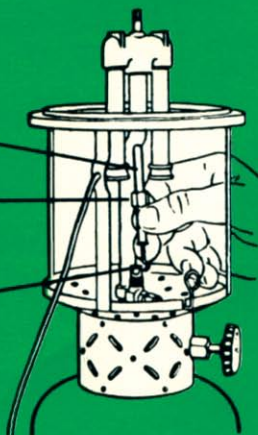

### CAMP STOVES

Join the fun. Select your favorite model and enjoy favorite meals everywhere — and for less cost than restaurant meals. Clean, quick, odorless cooking. Safe, too. Two- and three-burner models. Also available, Coleman Camp Oven; lets you bake to perfection anywhere.



# PARTS LIST FOR COLEMAN LANTERNS 220E and 228E

## PART NO. DESCRIPTION

17 - 508	Machine Screw (#4— 36x1/4 Rd. Hd. Brass)
021A306	(21A) Mantle (Pk'd 2)
15 - 053	Machine Screw (#6—32x3/16)
101 - 324	Tube (Burner)
104 - 147	*Nut (27/64—27 Hex)
112 - 3231	Cap (Burner)
118A3041	Eccentric Block
118B1361	Gasket (Filler Plug)
118B1381	Needle (Fuel and Air Tube)
118B2181	Gas Tip (Marked 5)
118B2381	Needle Assembly
118B620	Packing (Valve Stem)
200A5201	Plunger Ass'y (Pump)
202 - 6491	Wheel (Valve)
203 - 441	Nut (Ball)
216 - 509	Leather (Pump)
220B1401	Filler Cap
220B3221	Tube (Air Intake—Brass)
220B3261	Mixing Chamber (with Screw)
220B340	Rod (Ventilator)
220B3531	Stem (Tip Cleaner)
220B3571	Cleaner Ass'y (Gas Tip)
220B3991	Burner
220B4231	Bail
220B485	Ventilator
220B498	Frame and Bail
220B950	Wrench (Small)
220C6531	Stem Assembly
220D1461	Tube Assembly (Fuel and Air)
220D6571	Valve (Less Generator and Complete Ass'y)
220E1651	Fount (Complete)
220E289	(T44DL) Generator
220E4291	Base Rest
227 - 480	Ventilator
228B4241	Bail
228B498	Frame and Bail
228E429	Base Rest
242B532	Stem (Air)
242B5381	Check Valve
252B619	Disc (Direction)
4001 - 127	Screw (Sheet Metal #2x3/16 Type Z Bd. Hd.)
605 - 210	Jamb Nut
690 - 048	(330) Globe

\*Use 220B950 Wrench

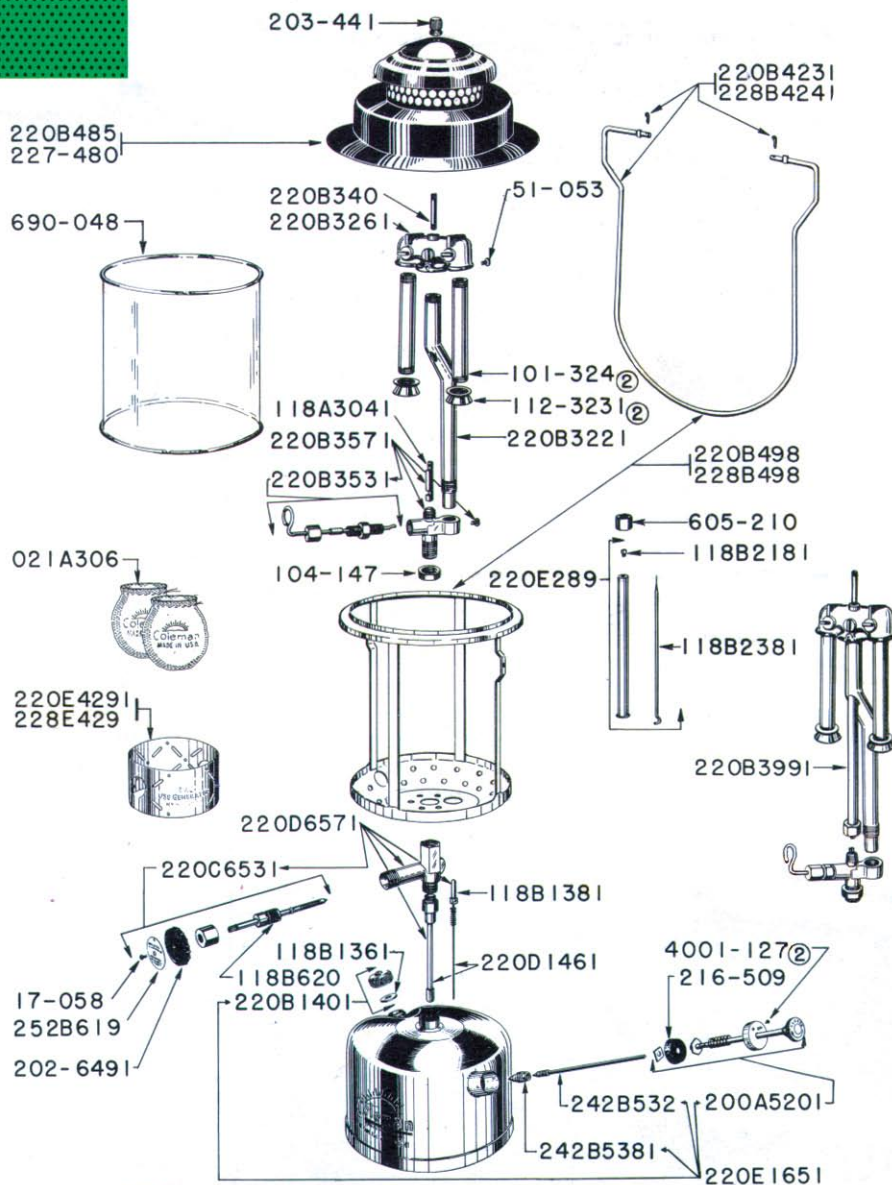

② Quantity of Parts Used in Assembly

See your Coleman Dealer for Repair Parts