

Turn on your WIFI

Connect your PC and Android to the WIFI

In your PC, run VLC

*If you do not have VLC, search VLC and download it*

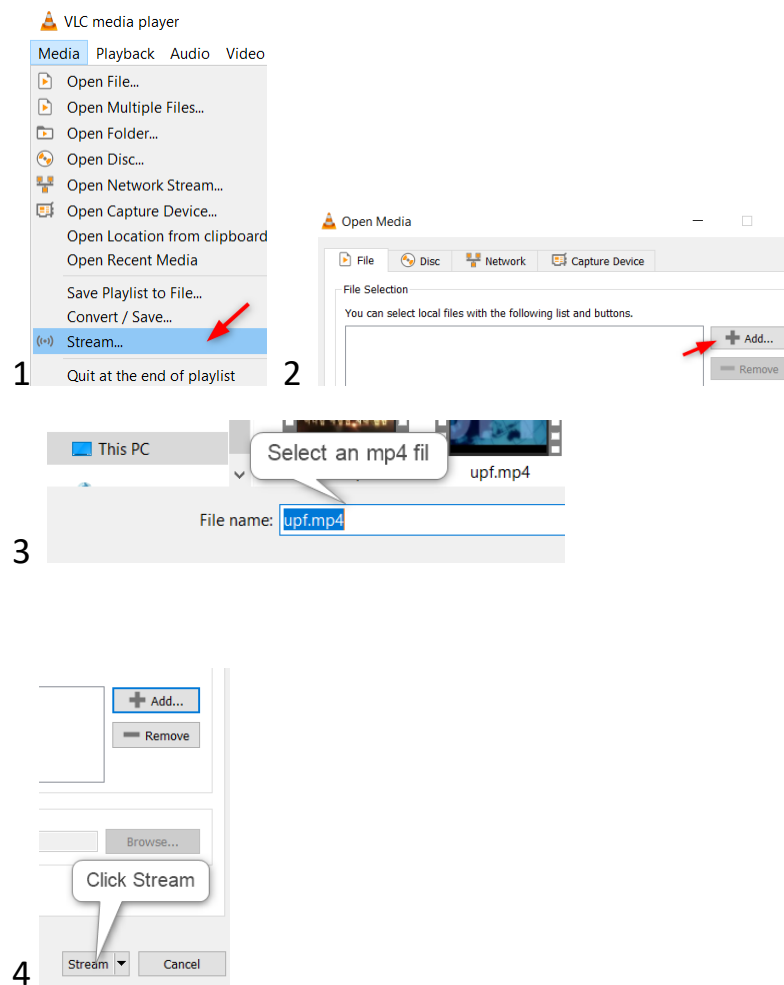

**Source**  
Set up media sources to stream

This wizard will allow you to stream or convert your media for use locally, on your private network, or Internet. You should start by checking that source matches what you want your input to be and then press the "Next" button to continue.

Source: D:\upf.mp4  
Type: file

Back Next

5

**Destination Setup**  
Select destinations to stream to

+ Add destinations following the streaming methods you need. Be sure to check with transcoding that the format is compatible with the method used.

New destination  
☐ Display locally

File  
File  
HTTP  
MS-WMSP (MMSH)  
RTSP  
RTP / MPEG Transport Stream  
RTP Audio/Video Profile  
UDP (legacy)

Add

Cancel

6

**Destination Setup**  
Select destinations to stream to

+ HTTP

This module outputs the transcoded stream to a network via HTTP.

Take note the port number

Port: 8080  
Path: /

Back Next

7

**Transcoding Options**  
Select and choose transcoding options

☐ Activate Transcoding

Profile: Unchecked

Select this.

Video - MPEG-2 + MPGA (TS)  
Video - H.264 + MP3 (MP4)  
Video - VP80 + Vorbis (Webm)  
Video - H.264 + MP3 (TS)  
Video - H.265 + MP3 (MP4)  
Video - Theora + Vorbis (OGG)  
Video - MPEG-2 + MPGA (TS)  
Video - Dirac + MP3 (TS)  
Video - WMV + WMA (ASF)  
Video - DIV3 + MP3 (ASF)  
Audio - Vorbis (OGG)

Back Next

8

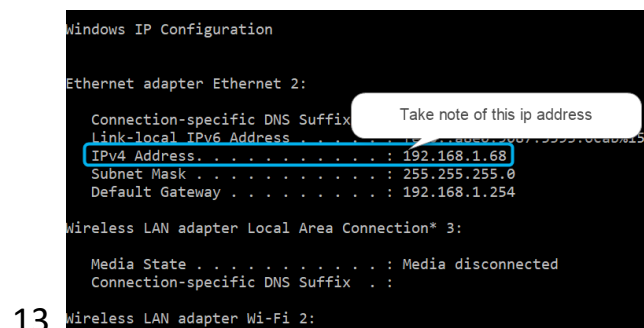
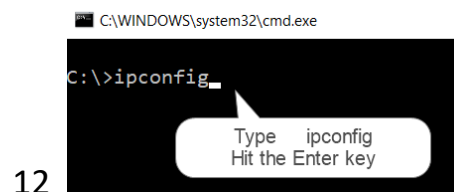
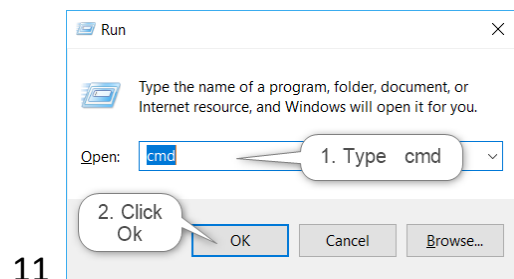
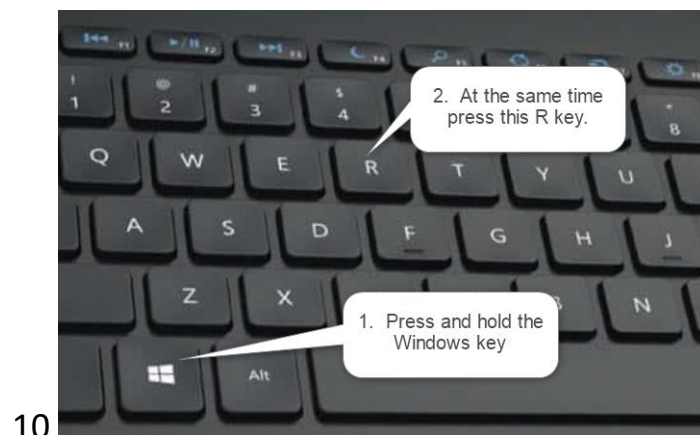
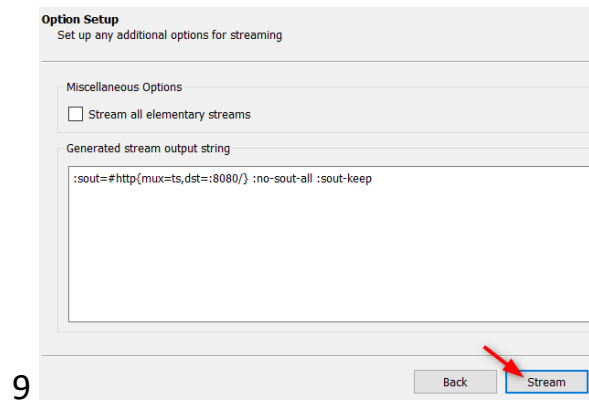

14 On your Android device, go to Google Play store and download VLC

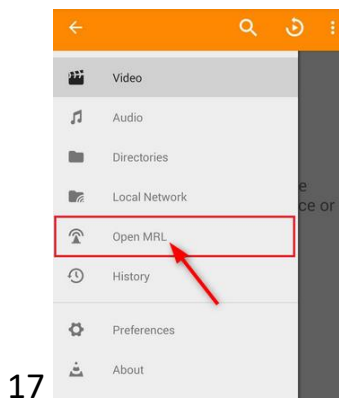
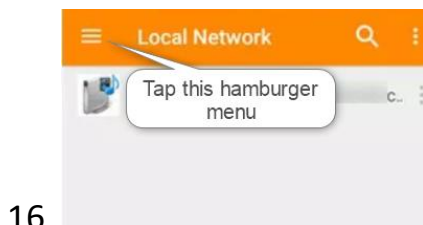
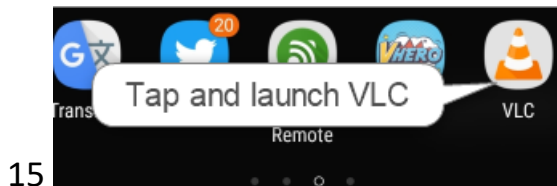
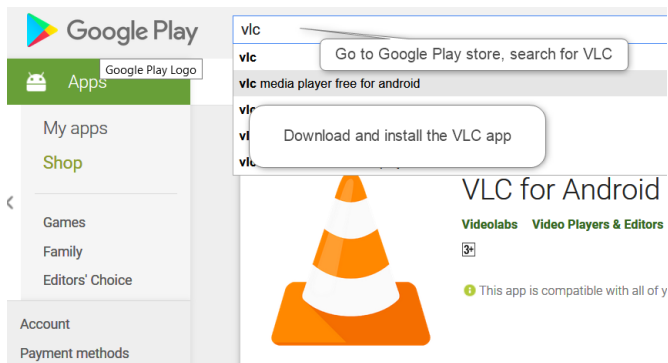

18

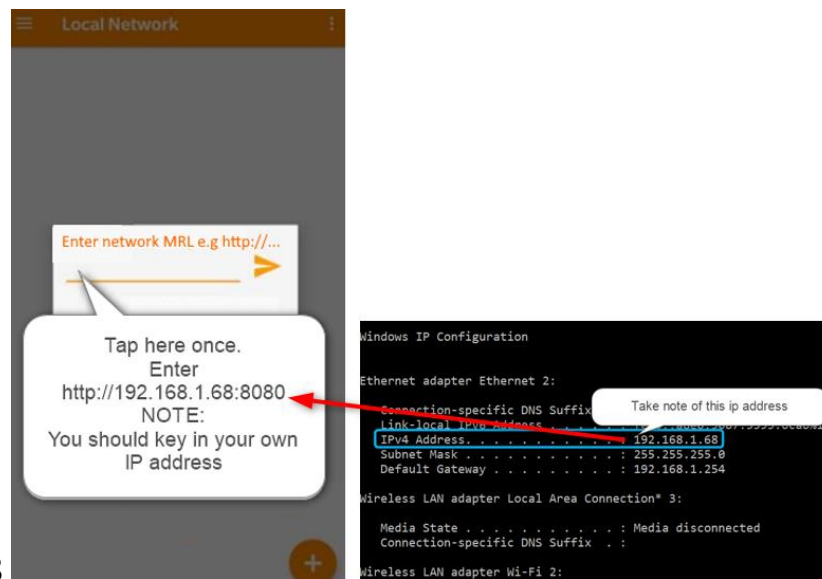

19



20 If everything goes well, the video should play on your Android device.